

**RIDING HALL 1.600 & 2.100 CM**



**TECHNICAL DATA**

STANDARDVERSION

Span	1.600 cm	2.100 cm
Side height	440 cm	440 cm
Ridge height	652 cm	722 cm
Roof pitch	15 °	15 °
Bay distance / grid	250 cm	250 cm
Main profile	220 x 100 x 3/4 mm	220 x 100 x 3/4 mm
Gable column	2	4
Min. setup length	1.500 cm	1.500 cm
Max. setup length	Expandable with the grid	Expandable with the grid
Snow load	0,85 kN/m <sup>2</sup> to 1,31 kN/m <sup>2</sup>	0,85 kN/m <sup>2</sup> to 1,31 kN/m <sup>2</sup>

- |           |   |
|-----------|---|
| Frame     | <ul style="list-style-type: none"> <li>· Anodized and high strength aluminum profile</li> <li>· Connection parts made of aluminum and galvanised steel</li> <li>· PVC-coated steel ropes</li> </ul>   |
| Tarpaulin | <ul style="list-style-type: none"> <li>· RÖDER No. 1, PVDF coated tarpaulin, according to DIN 18204</li> <li>· Color: green or white</li> <li>· Classified as 'difficult to ignite' by DIN 4102 and EN 13501</li> <li>· Dirt-repellent and light-resistant</li> <li>· Lets daylight through and is UV-resistant</li> <li>· Low-wick coated polyester threads</li> </ul> |

**RIDING HALL 1.600/440/652 & 2.100/440/722**

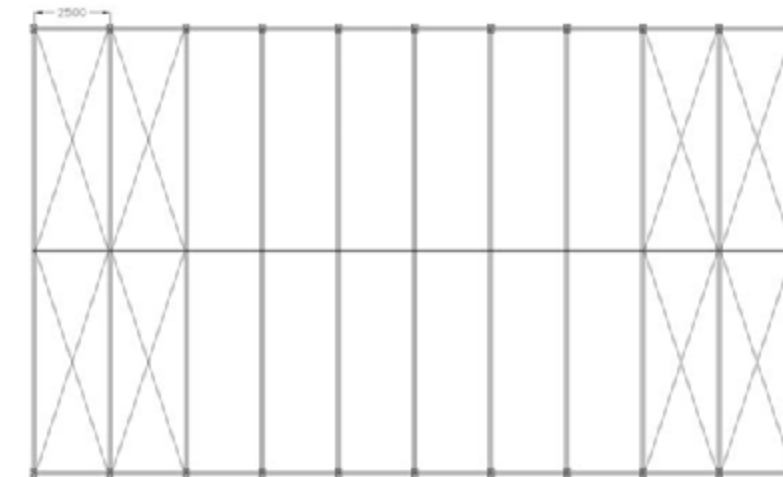
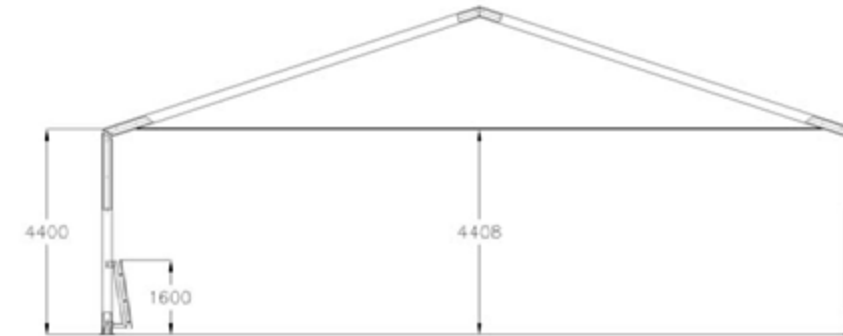

**QUESTIONS AND COMMENTS**

We have summarized the most important data and dimensions of our standard constructions for you. All information is without guarantee. No liability is assumed for printing and spelling errors. We would be happy to advise you personally about the optimal construction for your needs. Your Orgatent team is at your disposal to answer any questions you may have about intermediates, special features, conversions and other technical data.